

**KITCHEN SINK**

KS1141SS12SS



**Description**

- 304 Stainless Steel
- 16 Gauge
- Zero Radius Corners
- 25"x22"9"
- Drop in or undermount
- Sound deadening pads on sides and bottom of Sink
- Available with one, two or three holes

**Codes/Standards Applicable**

Specified model meets or exceeds the following:

- ASME A112.19.3

**Colors/Finishes**

- Stainless Steel

**KITCHEN SINK**  
KS1141SS12SS

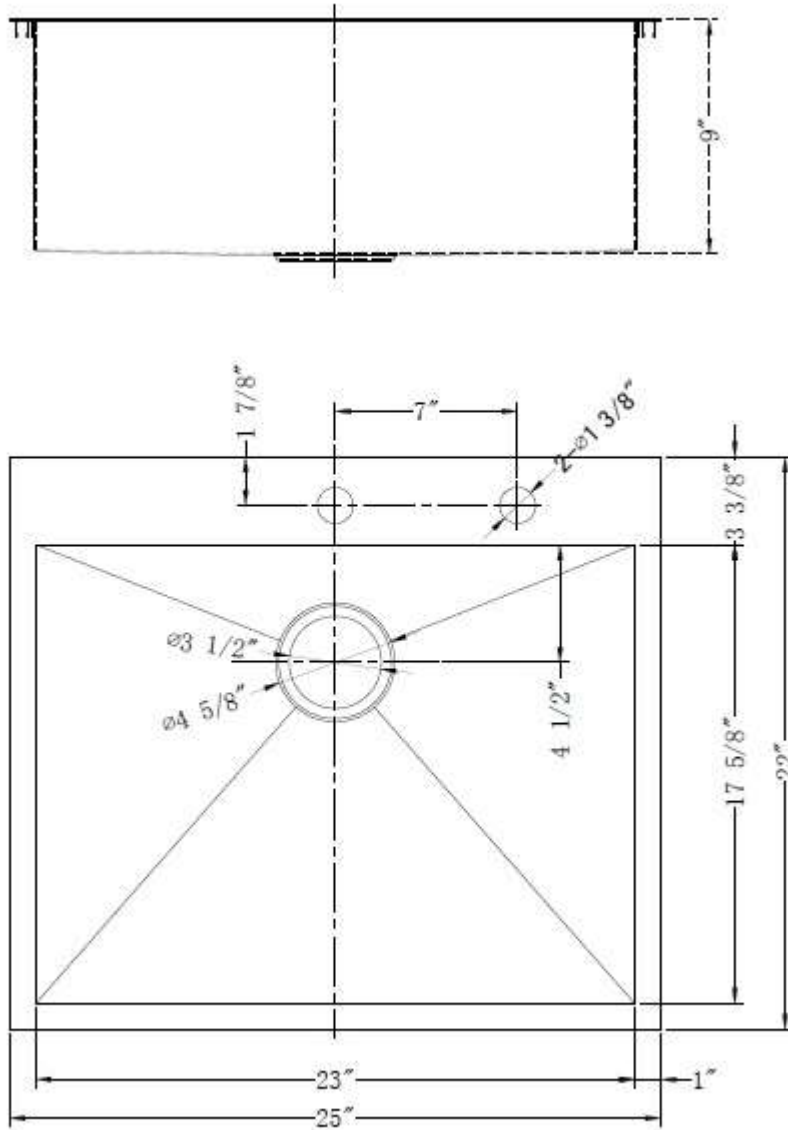

**Product Diagram**